

Crawl Space & Basement Technologies

The Crawl Space & Basement Specialists™

2650 Discovery Drive, Suite 100
Raleigh, North Carolina 27616
Phone: 919-847-7072 • Fax: 866-266-1652
www.CBTofNC.com
customerservice@cbtofnc.com

Customer: Tom & Libbie Glembocki
Address: 103 Downing Pl.
City: Apex State: NC Zip: 27502
Home: _____ Cell: 919-810-6692
Email: tomgle@gmail.com
Date of Visit: 4/25/12
Date of Start: _____ / _____ / _____ Estimated days: 1-4

_____ Basement ☒ Crawl Space _____ Attic

- Code
- Attic
 - Basement
 - Crawl Space
 - Outside Door
 - Furnace
 - Water Heater
 - Stairs
 - Toilet
 - Sink
 - ☒ Sump Pump
 - Window
 - Shower

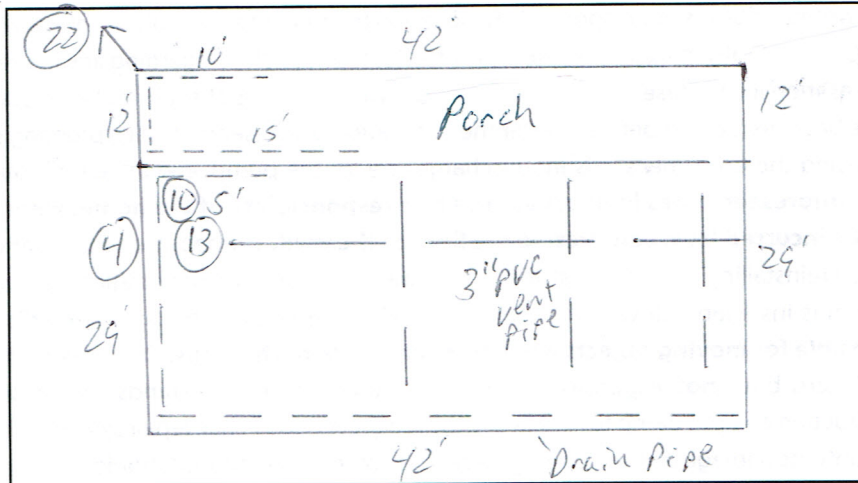

- ☒ Humid-Evac™
- Dehumidifier
- Fireplace
- Garage
- I-Beam
- Helical Pier
- Carbon Fiber Strip
- Angle Iron
- Pump Discharge
- Gravity Discharge
- _____
- _____
- _____

Furnace must be "Direct-Vent"

Wall LF 142 Floor SF 1218
Wall Height 3.5 Wall SF 497
Drainage Pipe SF 113 Other _____

Subcontractors: ☒ Electrician ☒ HVAC ☒ Plumber ☒ Insulation
_____ Credit Card _____ Check _____ Financing _____ Other

We Propose hereby, to furnish material and labor – complete, in accordance with above specifications, for the sum of: _____ dollars \$ _____
Deposit Required \$ 5 Deposit Paid \$ _____ Balance Due Upon installation \$ _____

PAYMENT TO BE MADE IN FULL TO FOREMAN UPON COMPLETION.
IF CREDIT CARD IS ON FILE, IT WILL AUTOMATICALLY BE PROCESSED ON FINAL DAY OF JOB.

All material is guaranteed to be as specified. All work to be completed in a workman-like manner according to the standard practices. Any alterations or deviation from above specifications involving extra costs will be executed only upon written orders, and will become an extra charge over and above the estimate. Property owner assumes all responsibility for damages due to breakage of any hidden fuel/utility service lines, though we will do our best to avoid such damage.

Authorized signature [Signature] Note: This proposal may be withdrawn by us if not accepted within 30 days.

Acceptance of Proposal – The above prices, specifications and conditions, listed on the front and back of this form, are satisfactory and are hereby accepted. CBT is authorized to do the work as specified. Payment will be made as outlined above. Date of Acceptance _____

Authorized signature [Signature]
Authorized signature _____

Crawl Space & Basement Technologies

The Crawl Space & Basement Specialists™

Customer: Tom & Libbie Glenbeck

- ☒ Premium Sealed Crawl
- ☐ Basic Sealed Crawl Space
- ☒ Drainage Only
- ☐ Foundation Repair

Option # _____

WATER PROOFING

Drainage Pipe	<u>115</u> LF	X	<u>20</u> /LF	= \$ <u>2260</u>
Sump Pump System	<u>1</u> Qty		<u>3/4</u> HP	= \$ <u>950</u>
Gravity Discharge	_____ LF	X	_____ /LF	= \$ <u>125</u>
Battery Back-up System				= \$ _____
Electrician				= \$ <u>Not included</u>

Part I
Drainage
\$3,335.00

ENCAPSULATION

12 Mil Liner	<u>1218</u> SF	X	<u>1.75</u> /SF	= \$ <u>2132</u>
20 Mil Liner	_____ SF	X	_____ /SF	= \$ _____
6 Mil Vapor Barrier	_____ SF	X	_____ /SF	= \$ _____
Rigid Wall Panel	_____ SF	X	_____ /SF	= \$ _____
Crawl Space Prep				= \$ _____
Large Dehumidifier	_____ Qty			= \$ _____
Small Dehumidifier	_____ Qty			= \$ _____
Humid-Evac	<u>1</u> Qty			= \$ <u>950</u>
Take-off Vent-Supply Air	<u>1</u> Qty			= \$ <u>225</u>
Crawl Space Door Weather Strip or Replace (Number of Doors <u>1</u>)				= \$ <u>75</u>

main
crawl
space

INSULATION

Remove Insulation	<u>1218</u> SF	X	<u>40</u> /SF	= \$ <u>487</u>
Closed-cell Spray Foam	<u>497</u> SF	X	<u>3.50</u> /SF	= \$ <u>1740</u>
Open-cell Spray Foam	_____ SF	X	_____ /SF	= \$ _____
R-19 Fiberglass	_____ SF	X	_____ /SF	= \$ _____
R-10 Foam Board	_____ SF	X	_____ /SF	= \$ _____

Part II
Encapsulation
\$7,177.00

MOLD REMEDIATION

Light Clean	<u>1218</u> SF	X	<u>1</u> /SF	= \$ <u>1218</u>
Heavy Clean	_____ SF	X	_____ /SF	= \$ _____
Microban Only	_____ SF	X	_____ /SF	= \$ _____
Air Scrubber Rental	_____ Days			= \$ _____
Dehumidifier Rental	_____ Days			= \$ _____
Air Mover Rental	_____ Days			= \$ _____

FOUNDATION REPAIR

Steel I-Beams	_____ Qty	X	\$ _____	= \$ _____
Helical Piers	_____ Qty	X	\$ _____	= \$ _____
Floor Jacks	_____ Qty	X	\$ _____	= \$ _____
Carbon Fiber Strips	_____ Qty	X	\$ _____	= \$ _____
Angle Iron	_____ LF	X	\$ _____	= \$ _____

OTHER CHARGES (see attached)

Apex Permits

= \$ 350

TOTAL ESTIMATE

\$

10,512

- 10% if done together = \$ 9,460.00